

Technical specifications



SKIDSTEER LOADERS LOW FLOW UP TO 50 HP

MINI EXCAVATORS 2 - 4 T (4,400 - 8,800 Lbs)

S4 AUGERS 100mm-600mm (4 in. - 24 in.) Dia

Torque Range: 959-2,877 Nm (707-2,122 ft-lb)

Oil Pressure Range: 80-240 Bar (1,160-3,481 psi)

Oil Flow Range: 27-75 lpm (7-20 gpm)

Speed Range: 36-100 rpm

Unit Weight: 71 kg (157 lbs)

Hitch Options: Single Pin Hitch
Double Pin Hitch
Cradle Hitch

Output Shaft Std: 65mm (2.56") Round

Output Shaft Opt: 2" (50.8mm) Hex
57mm (2.25") Square

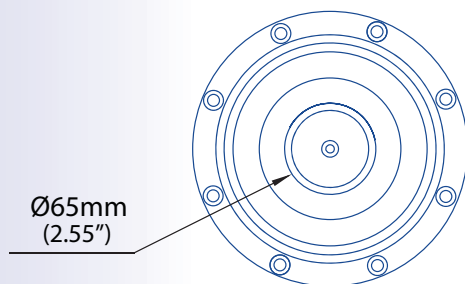
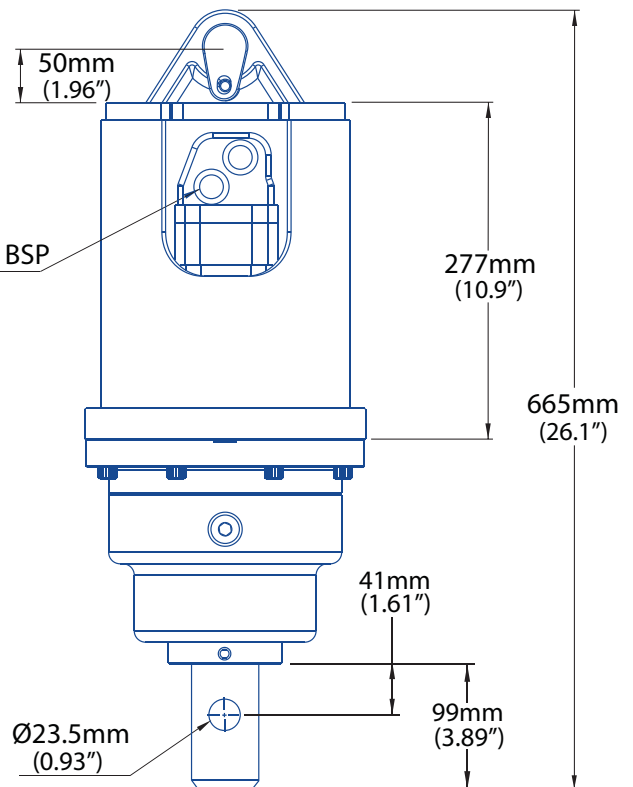
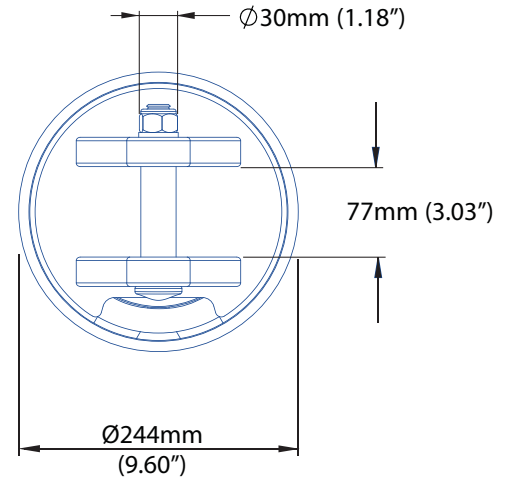

HOSE PORT Ø 1/2" BSP